

NOSE LARGE PUNCHES

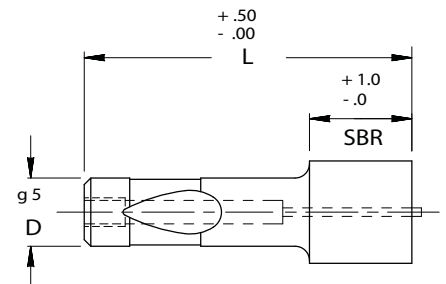

HEAVY DUTY/EJECTOR

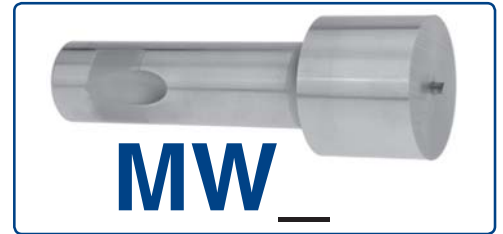
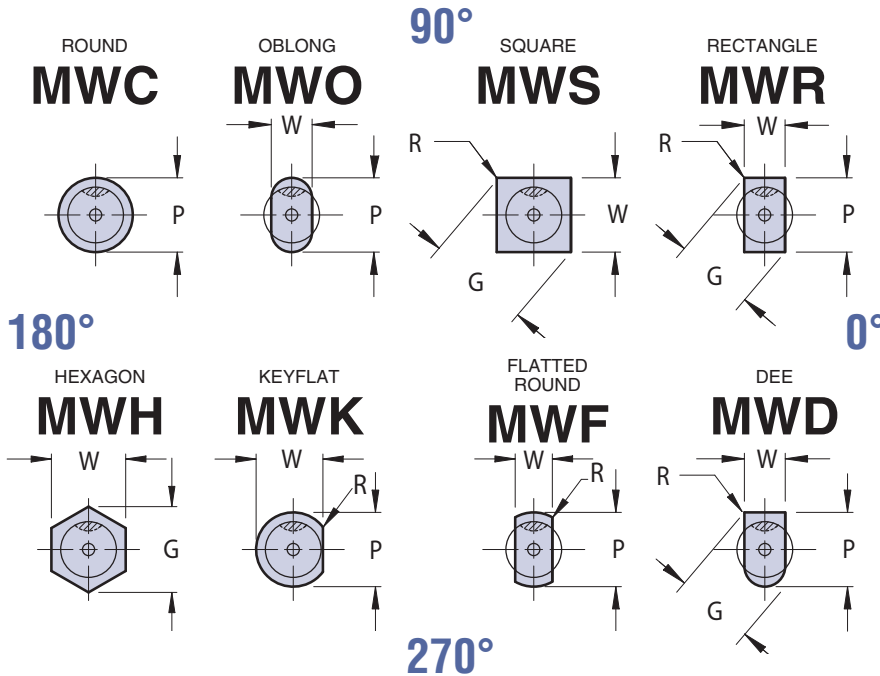

ORDER EXAMPLE:

(Reference page 4)

SPECIFY: QTY: TYPE "D" "L" DIMENSIONS P (OR P&W)

EXAMPLE: 6 MWO 16 90 12.0 x 7.0

Note: When ordering, standard quantity breaks are: 1, 2-3, 4-11, 12-23, 24-49, 50-99

VIEWS ARE SHOWN LOOKING THROUGH THE SHANK BUT DRAWN WITH SOLID LINES FOR CLARITY.

Complete design & CAD files visit WWW.MOELLERMCAD.COM

FOR STANDARD ALTERATIONS SEE PAGES 59-63.

| CATALOG TYPE | SHANK DIA D | POINT LENGTH "S.B.R." | ROUND | SHAPE | | OVERALL LENGTH "L" | | | EJECTOR SIZE |
|--------------|-------------|-----------------------|---------------|-------|---------|--------------------|----|-----|--------------|
| | | | RANGE P | MIN W | MAX G/P | 80 | 90 | 100 | |
| MW_10 | 10 | 16 | 10.10 - 25.00 | 3.00 | 25.00 | X | X | X | MAE 4 |
| MW_13 | 13 | 20 | 13.10 - 32.00 | 5.00 | 32.00 | X | X | X | MAE 5 |
| MW_16 | 16 | 25 | 16.10 - 38.00 | 6.00 | 38.00 | X | X | X | MAE 5 |
| MW_20 | 20 | 25 | 20.10 - 40.00 | 8.00 | 40.00 | X | X | X | MAE 6 |
| MW_25 | 25 | 25 | 25.10 - 47.00 | 10.00 | 47.00 | X | X | X | MAE 6 |
| MW_32 | 32 | 32 | 32.10 - 63.00 | 11.50 | 63.00 | X | X | X | MAE 6 |
| MW_40 | 40 | 32 | 40.10 - 63.00 | 14.00 | 63.00 | X | X | X | MAE 6 |

Material

Steel: M2, HRC 60-63

Standard Point Tolerance

Round P $\begin{matrix} +.01 \\ -.00 \end{matrix}$

| | | |
|--|-----|--------|
| | .01 | P to D |
|--|-----|--------|

Shape P, W $\pm .01$

| | | |
|--|-----|--------|
| | .02 | P to D |
|--|-----|--------|

STANDARD BALL SEAT LOCATION IS AT 90° AS SHOWN. AVAILABLE AT 0°, 180°, 270°, FOR SAME PRICE.