

# BALL LOCK PUNCHES

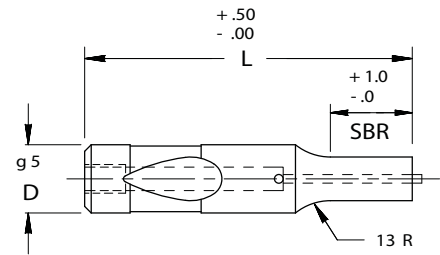

## HEAVY DUTY/EJECTOR

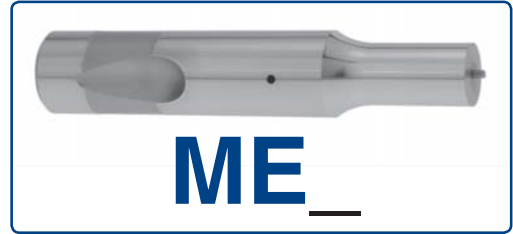
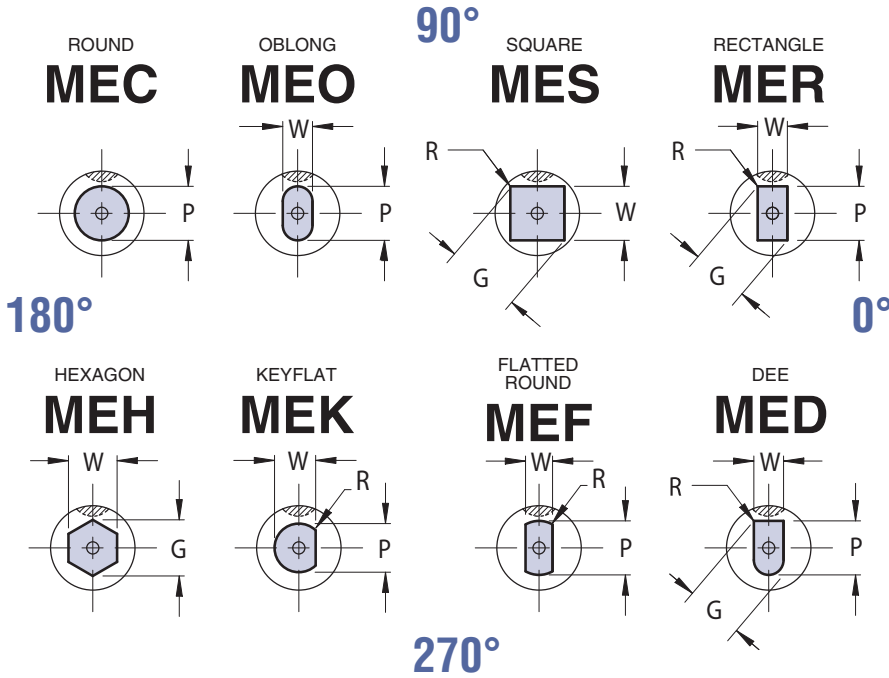

**ORDER EXAMPLE:**  
 (Reference page 4)  
**SPECIFY:** QTY: TYPE "D" "L" POINT LENGTH P(OR P&W) DIMENSIONS  
 EXAMPLE: 6 MEC 10 90 B 5.0  
 EXAMPLE: 6 MEO 16 80 STD 14.0 x 8.0  
 Note: When ordering, standard quantity breaks are: 1, 2-3, 4-11, 12-23, 24-49, 50-99

VIEWS ARE SHOWN LOOKING THROUGH THE SHANK BUT DRAWN WITH SOLID LINES FOR CLARITY.

FOR STANDARD ALTERATIONS SEE PAGES 59-63.

Complete design & CAD files visit [WWW.MOELLERMCD.COM](http://WWW.MOELLERMCD.COM)

CATALOG TYPE	SHANK DIA D	ROUND	SHAPE		OVERALL LENGTH "L"						
		RANGE P	MIN W	MAX G/P	63	71	80	90	100	110	125
ME_10	10	2.50 - 9.98	2.50	10.00	X	X	X	X	X	X	
ME_13	13	5.00 - 12.98	4.50	13.00	X	X	X	X	X	X	X
ME_16	16	8.00 - 15.98	6.00	16.00	X	X	X	X	X	X	X
ME_20	20	12.00 - 19.98	8.00	20.00	X	X	X	X	X	X	X
ME_25	25	16.00 - 24.98	10.00	25.00			X	X	X	X	X
ME_32	32	24.00 - 31.98	12.00	32.00			X	X	X	X	X
ME_40	40	30.00 - 39.98	14.00	40.00			X	X	X	X	X

**Material**  
 Steel: M2, HRC 60-63

**Standard Point Tolerance**

Round P  $\begin{matrix} +.01 \\ -.00 \end{matrix}$  .01 P to D

Shape P, W  $\pm .01$  .02 P to D

When P = D Shank Tolerances Apply

CATALOG TYPE	SHANK D	SBR			EJECTOR SIZE
		NAPMA STD	ALTERNATES B	C	
ME_10	10	19	10	—	MAE 4
ME_13	13	19	13	25	MAE 5
ME_16	16	19	13	25	MAE 5
ME_20	20	19	13	25	MAE 6
ME_25	25	19	13	25	MAE 6
ME_32	32	19	13	25	MAE 6
ME_40	40	25	19	30	MAE 6

L=63 SBR MAX=19 XP ALTERATION NOT AVAILABLE  
 L=71 SBR MAX=19 IF L=63 AND SBR=19

STANDARD BALL SEAT LOCATION IS AT 90° AS SHOWN. AVAILABLE AT 0°, 180°, 270°, FOR SAME PRICE.