

BALL LOCK PUNCHES

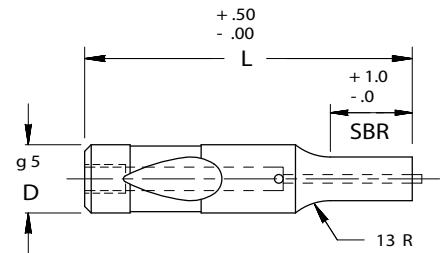

HEAVY DUTY/EJECTOR

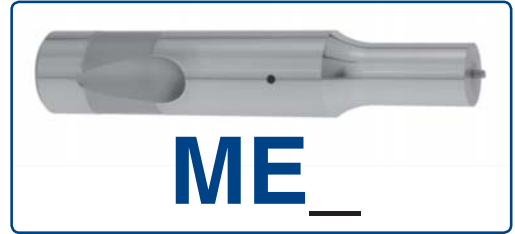
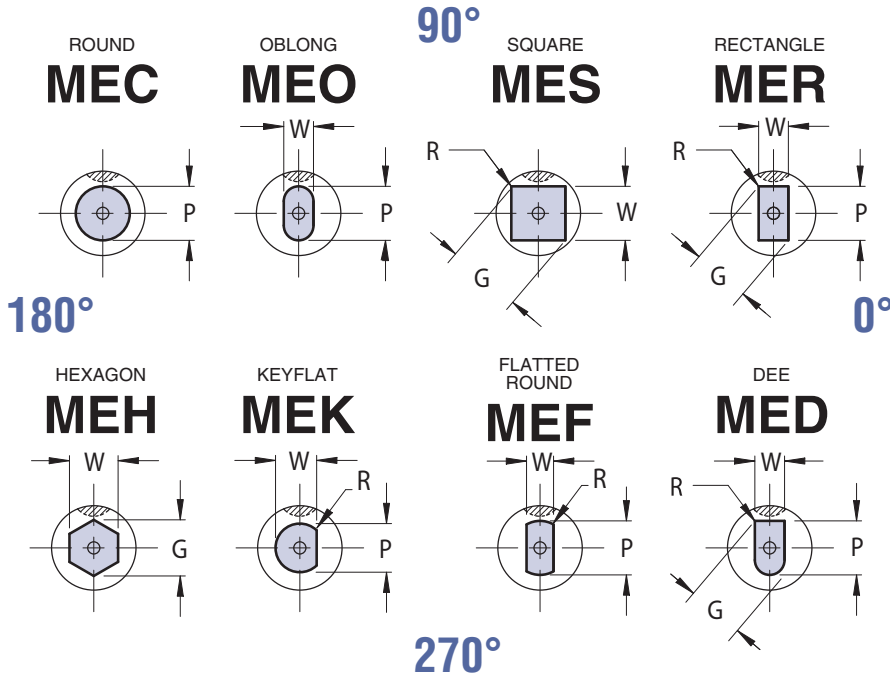

ORDER EXAMPLE:

(Reference page 4)

SPECIFY:	QTY:	TYPE	"D"	"L"	POINT LENGTH	P (OR P&W) DIMENSIONS
EXAMPLE:	6	MEC	10	90	B	5.0
EXAMPLE:	6	MEO	16	80	STD	14.0 x 8.0

Note: When ordering, standard quantity breaks are: 1, 2-3, 4-11, 12-23, 24-49, 50-99

VIEWS ARE SHOWN LOOKING THROUGH THE SHANK BUT DRAWN WITH SOLID LINES FOR CLARITY.

FOR STANDARD ALTERATIONS SEE PAGES 59-63.

Complete design & CAD files visit WWW.MOELLERMCAD.COM

CATALOG TYPE	SHANK DIA D	ROUND	SHAPE		OVERALL LENGTH "L"						
		RANGE P	MIN W	MAX G/P	63	71	80	90	100	110	125
ME_10	10	2.50 - 9.98	2.50	10.00	X	X	X	X	X	X	
ME_13	13	5.00 - 12.98	4.50	13.00	X	X	X	X	X	X	X
ME_16	16	8.00 - 15.98	6.00	16.00	X	X	X	X	X	X	X
ME_20	20	12.00 - 19.98	8.00	20.00	X	X	X	X	X	X	X
ME_25	25	16.00 - 24.98	10.00	25.00			X	X	X	X	X
ME_32	32	24.00 - 31.98	12.00	32.00			X	X	X	X	X
ME_40	40	30.00 - 39.98	14.00	40.00			X	X	X	X	X

Material

Steel: M2, HRC 60-63

Standard Point Tolerance

Round P $\begin{matrix} +.01 \\ -.00 \end{matrix}$

	.01	P to D
--	-----	--------

Shape P, W $\pm .01$

	.02	P to D
--	-----	--------

When P = D Shank Tolerances Apply

CATALOG TYPE	SHANK D	SBR			EJECTOR SIZE
		NAPMA STD	ALTERNATES B	C	
ME_10	10	19	10	—	MAE 4
ME_13	13	19	13	25	MAE 5
ME_16	16	19	13	25	MAE 5
ME_20	20	19	13	25	MAE 6
ME_25	25	19	13	25	MAE 6
ME_32	32	19	13	25	MAE 6
ME_40	40	25	19	30	MAE 6

L=63 SBR MAX=19
L=71 SBR MAX=19

XP ALTERATION NOT AVAILABLE
IF L=63 AND SBR=19

STANDARD BALL SEAT LOCATION IS AT 90° AS SHOWN. AVAILABLE AT 0°, 180°, 270°, FOR SAME PRICE.