



# Ejector sleeve, nitrided, DIN ISO 8405

Material: 264.8.

NWA  
Order No **264.8**.  
Hardness:  
Shaft\*  $\geq 950$  HV 0,3  
Head  $45 \pm 5$  HRC  
Tensile Strength (core)  $> 1400$  N/mm<sup>2</sup>

Description of FIBRO materials for tool and die components see at the beginning of Chapter E.

**Execution:**  
Shank nitrided and precision ground.  
Head hot upset-forged.  
Guide bore precision ground and honed.

**Note:**  
\*Owing to thinness of nitrided skin, hardness testing on shank restricted to Vickers only.  
Test load = 3 N max.

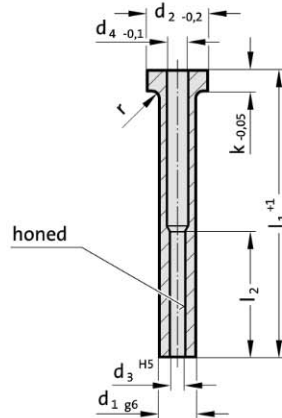

## 264.8. Ejector sleeve, nitrided, DIN ISO 8405

d <sub>1</sub>	d <sub>3</sub>	d <sub>4</sub>	d <sub>2</sub>	k	r	l <sub>2</sub>	l <sub>1</sub>	l <sub>1</sub>	l <sub>1</sub>	l <sub>1</sub>	l <sub>1</sub>	l <sub>1</sub>	l <sub>1</sub>	l <sub>1</sub>	l <sub>1</sub>
							75	100	125	150	175	200	225	250	275
3	1.5	1.8	6	3	0.3	35	●	●	●	●					
3	1.6	1.9	6	3	0.3	35	●	●	●	●					
4	2	2.4	8	3	0.3	35	●	●	●	●					
4	2.2	2.4	8	3	0.3	35	●	●	●	●					
5	2.5	3	10	3	0.3	35	●	●	●	●					
5	2.7	3	10	3	0.3	45	●	●	●	●					
5	3	3.3	10	3	0.3	45	●	●	●	●	●				
5	3.2	3.5	10	3	0.3	45	●	●	●	●	●				
6	3.5	4	12	5	0.5	45	●	●	●	●	●				
6	3.7	4	12	5	0.5	45	●	●	●	●	●				
6	4	4.3	12	5	0.5	45	●	●	●	●	●	●			
8	4.2	5	14	5	0.5	45	●	●	●	●	●	●			
8	5	5.3	14	5	0.5	45	●	●	●	●	●	●			
8	5.2	5.5	14	5	0.5	45	●	●	●	●	●	●			
10	6	6.3	16	5	0.5	45	●	●	●	●	●	●	●		
10	6.2	6.5	16	5	0.5	45	●	●	●	●	●	●	●	●	
12	8	8.3	20	7	0.8	45	●	●	●	●	●	●	●	●	●
12	8.2	8.5	20	7	0.8	45	●	●	●	●	●	●	●	●	●
14	10	10.3	22	7	0.8	45	●	●	●	●	●	●	●	●	●
14	10.2	10.5	22	7	0.8	45	●	●	●	●	●	●	●	●	●
16	12	12.3	22	7	0.8	45	●	●	●	●	●	●	●	●	●

### Ordering Code (example):

Ejector sleeve, nitrided, DIN ISO 8405 = **264.8**.  
 Diameter ejector pin d<sub>3</sub> 4 mm = 0400.  
 Length l<sub>1</sub> 75 mm = 075  
 Order No = **264.8.0400.075**